



WELCOME to ESS

ANISSA: Advanced Neutron Imaging for Solid-State Batteries in Action

a Röntgen-Ångström Cluster project

Project Meeting 02 May 2022

<https://indico.esss.lu.se/event/3016/>

AGENDA



10:00	→ 10:15	Welcome and short presentation about ESS Speakers: Kristina Edström , Robin Woracek	🕒 15m	✎
10:15	→ 10:30	Short overview of the project to remember Speaker: Kristina Edström	🕒 15m	✎
10:30	→ 11:30	Short update from the different partners Including: - progress on PhD/postdoc projects - update on Electrochemical cell designs Speaker: ALL	🕒 1h	✎
11:30	→ 12:30	Visit of Instrument Halls/Labs Speakers: Manuel Morgano, Robin Woracek	🕒 1h	✎
12:30	→ 13:30	LUNCH	🕒 1h	✎
13:30	→ 16:00	How to implement the project into practice Including: - Open Legal Issues - Beamtime applications (ILL deadline is 7 Sep 2022; PSI deadline: 15 May 2022) - Plan X-Ray CT for ESS (Søren Schmidt will join for that part; discussion can continue Tuesday in sub-group) - How to work together Speaker: ALL	🕒 2h 30m	✎
16:00	→ 16:30	Summary and next steps Speaker: Kristina Edström	🕒 30m	✎
16:30	→ 17:30	A quick bite downtown	🕒 1h	✎

Short Overview of ESS & ODIN

Instruments

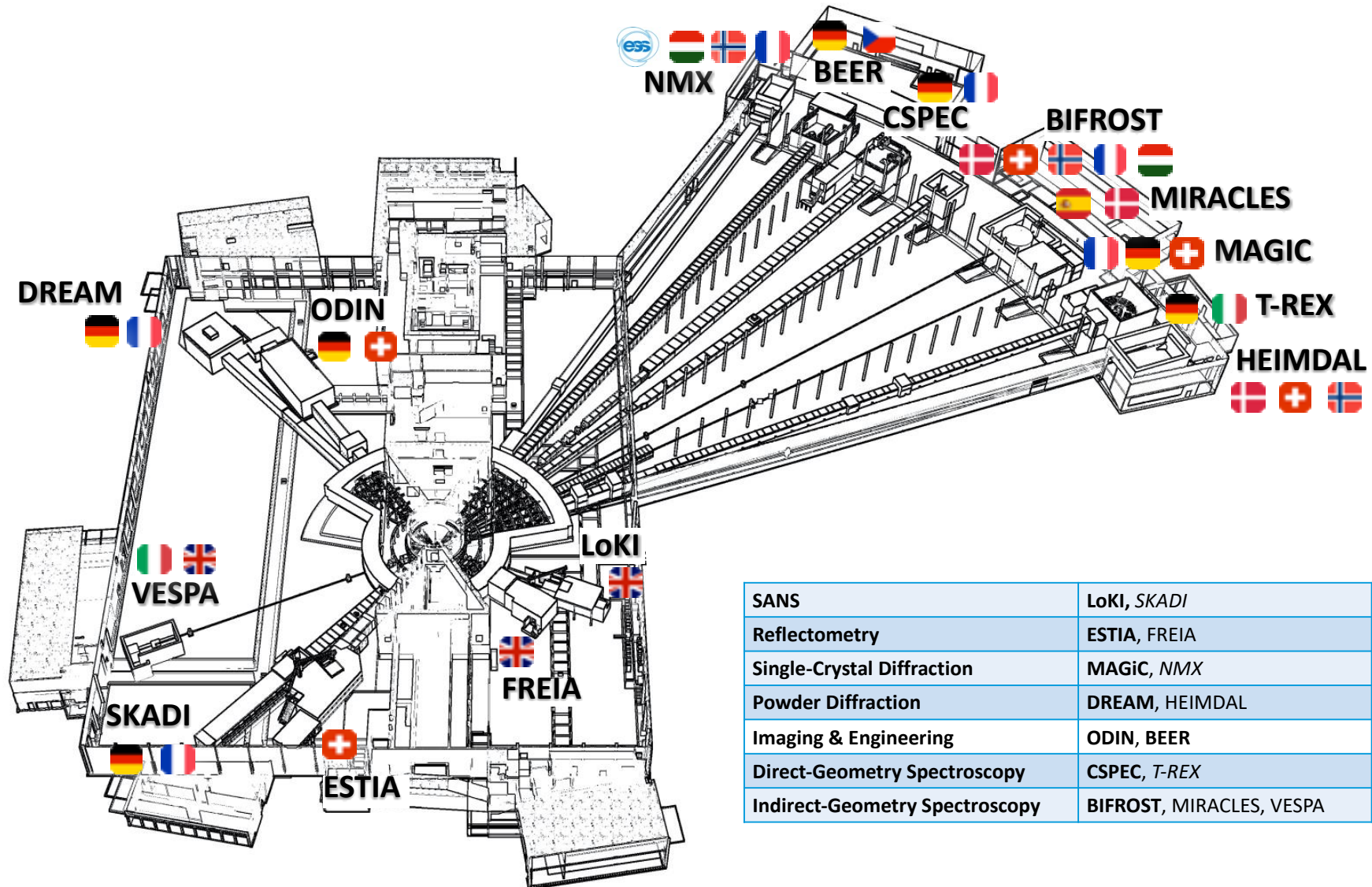

SANS	LoKI, SKADI
Reflectometry	ESTIA, FREIA
Single-Crystal Diffraction	MAGiC, NMX
Powder Diffraction	DREAM, HEIMDAL
Imaging & Engineering	ODIN, BEER
Direct-Geometry Spectroscopy	CSPEC, T-REX
Indirect-Geometry Spectroscopy	BIFROST, MIRACLES, VESPA

Short Overview of ESS & ODIN

Construction highlights

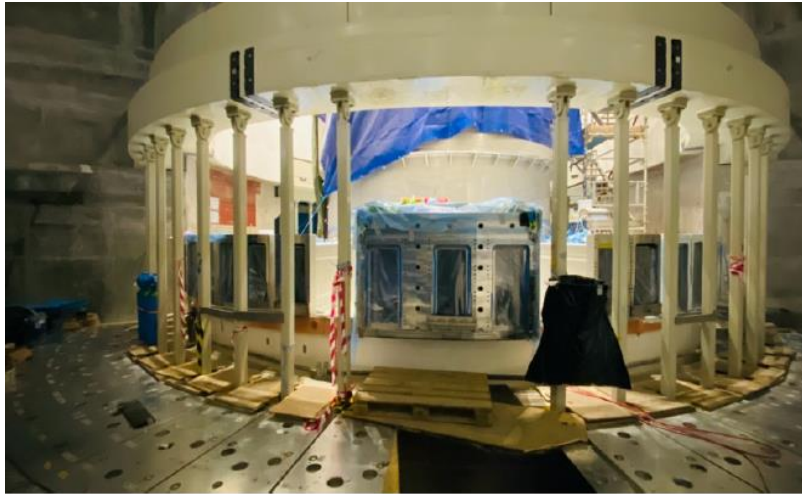

Port tube assemblies during installation 2021.

Odin control cabin



Dream Cave and control cabin



Installation of LOKI tank, cabin, bunker wall optics



Short Overview of ESS & ODIN

ESS ILL user meeting 2022 in Lund



5th -7th October

Venue: Central Lund, AF Borgen

8 Plenary speakers
from across Europe



Sessions on hot topics

Conference dinner in
AF Borgen

ESS site visit including
poster session and
mingle

Short Overview of ESS & ODIN

ODIN team



ODIN construction core team



Aureliano Tartaglione
ODIN Scientist (TUM)



Elbio Calzada
ODIN Lead Engineer (TUM)



Virginia Martinez Monge
ODIN Installation Engineer (TUM)



Michael Schulz
Head of Imaging group (TUM)



Manuel Morgano
ODIN Scientist (PSI/ESS)



Markus Strobl
Head of Imaging group (PSI)



Jan Hovind
Technician of Imaging Group (PSI)



Robin Woracek
Instrument Class Coordinator (ESS)



Søren Schmidt
Instrument Data Scientist for ODIN, BEER & TBL (ESS)



Alexandre Gonçalves Gerke
MCA Engineer for ODIN (ESS)

Short Overview of ESS & ODIN

Neutron Imaging

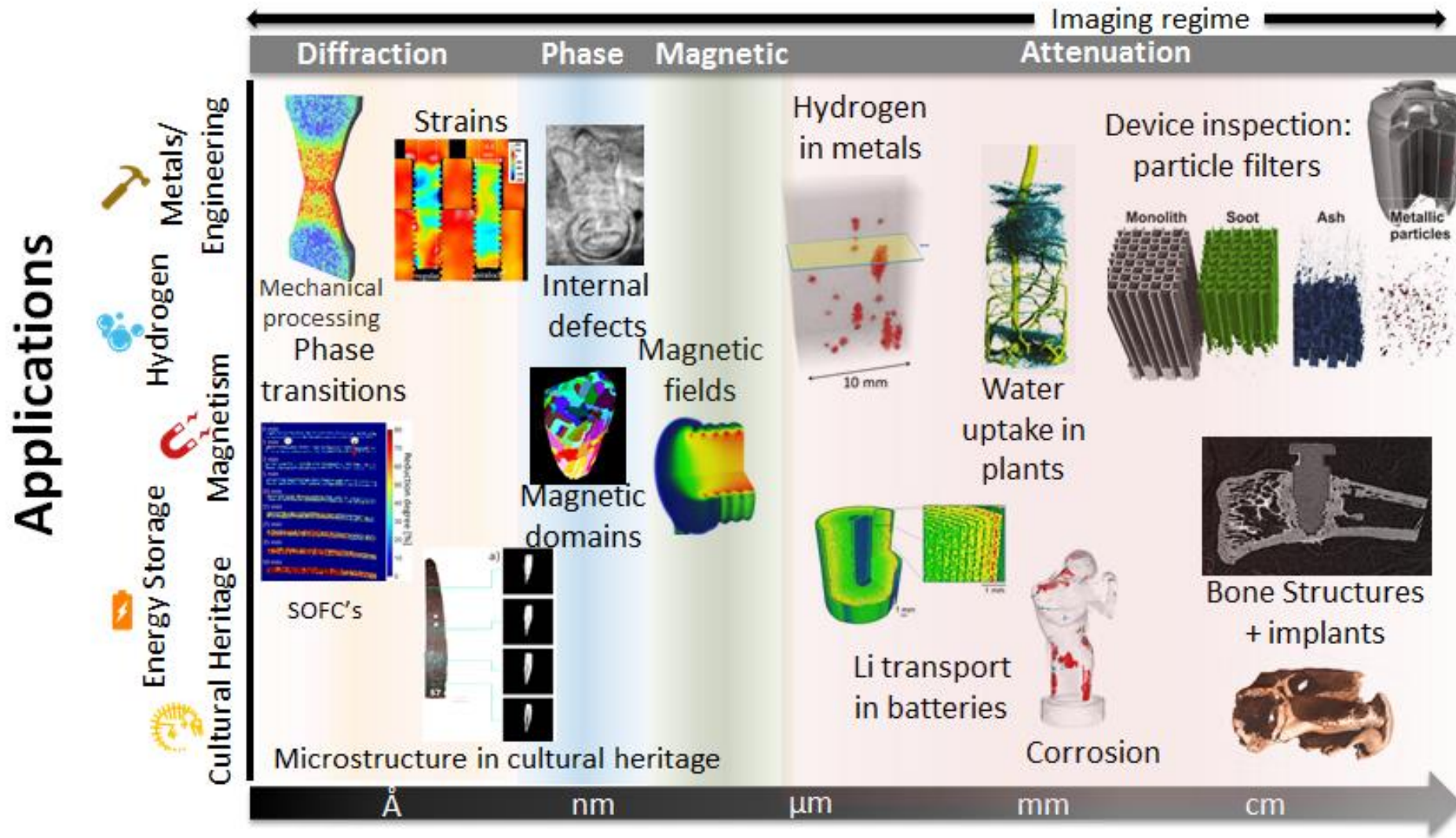

Short Overview of ESS & ODIN

ODIN beamline

K.H. Andersen, D.N. Argyriou, A.J. Jackson et al.

Nuclear Inst. and Methods in Physics Research, A 957 (2020) 163402

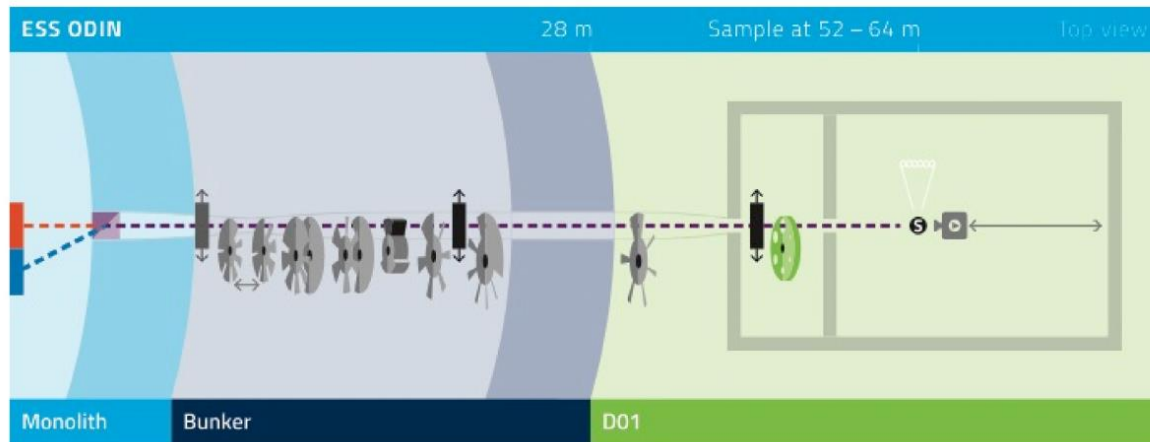
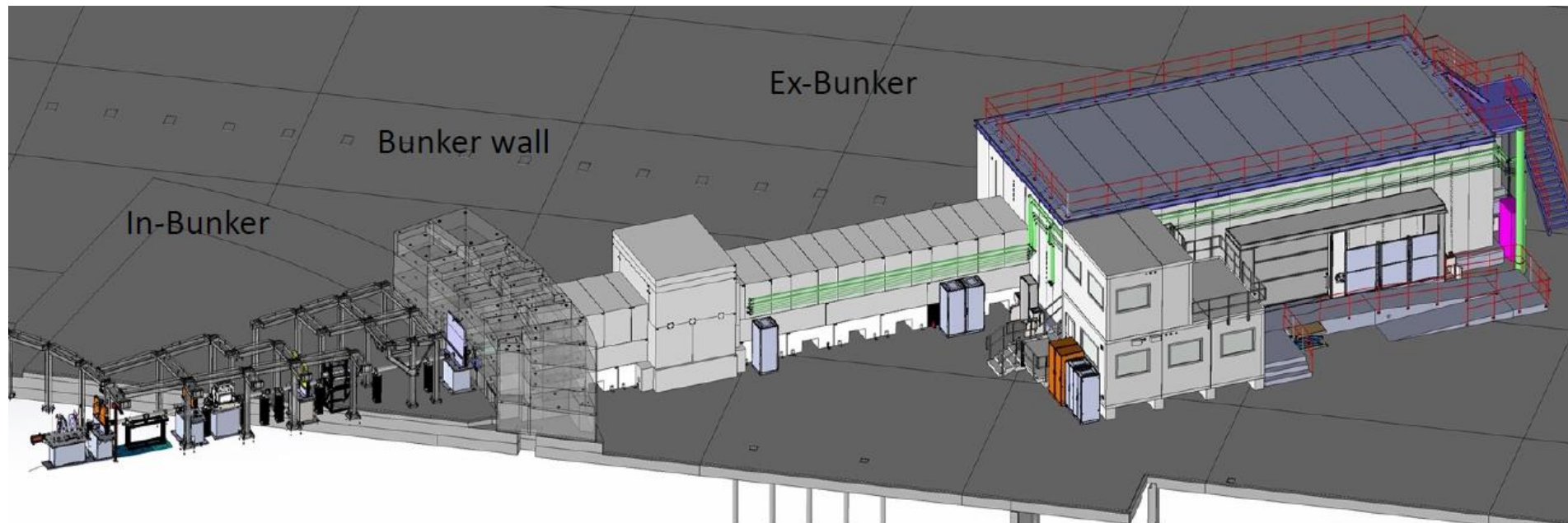
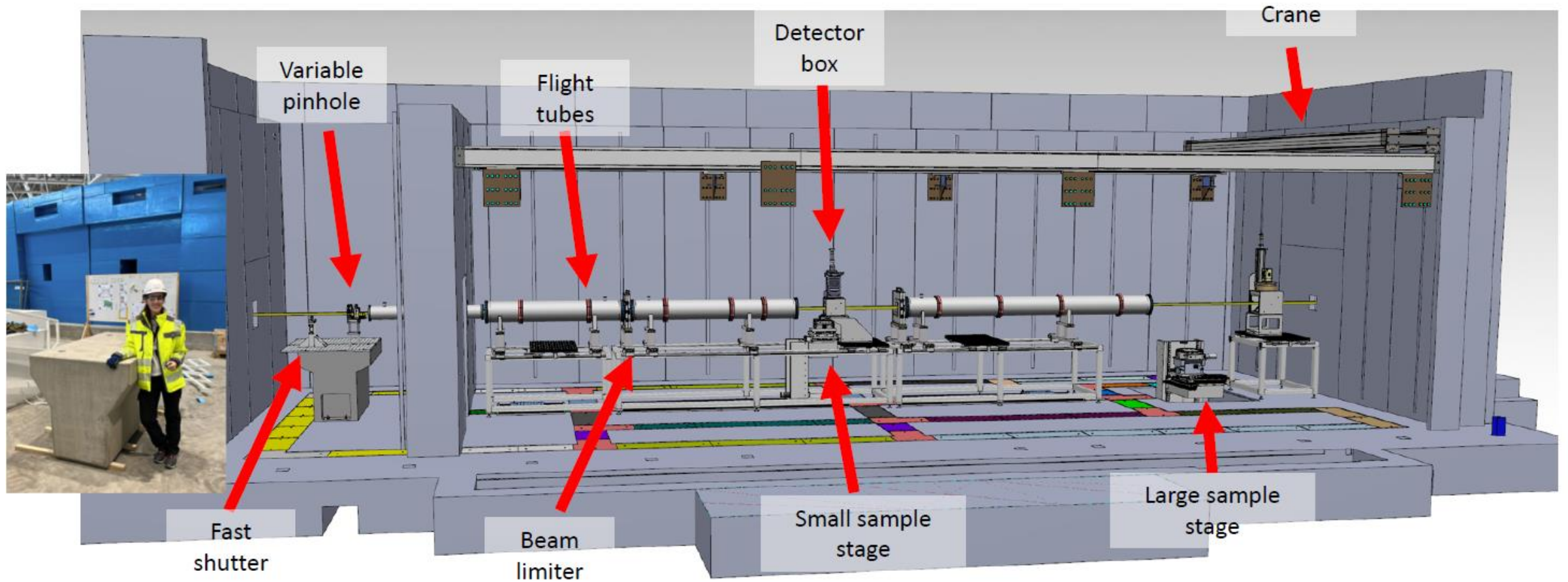

Fig. 19. ODIN instrument layout. Components shown in white are foreseen upgrades.



Short Overview of ESS & ODIN

ODIN beamline



Quick bite?



Thai <https://maeyai.com/>

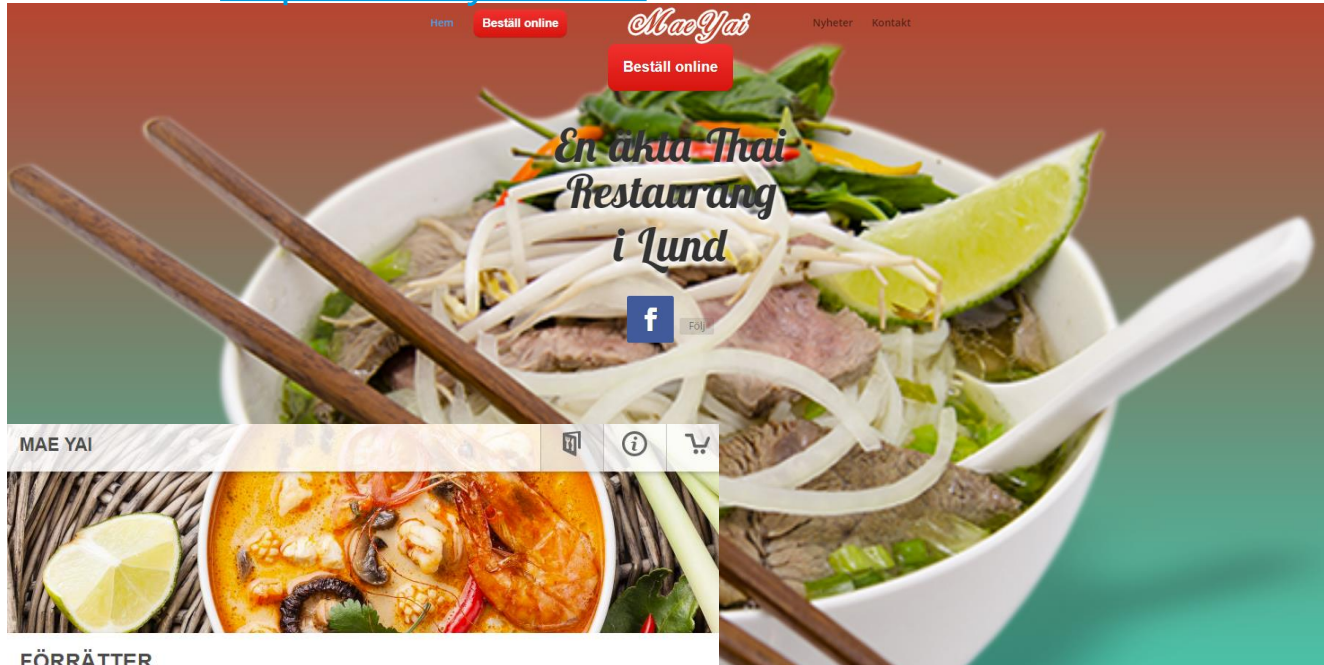

FÖRRÄTTER

F1 Satay (kycklingspett) med jordnötsås	50,00		F7. Tom ka kai (kokossoppa med kycklingfilé)	60,00
F2. Vårullar med sötsursås	55,00		F8. Thai chips med räksmak	50,00
F3. Veg vårullar med sötsursås	50,00		F9. Friterad kyckling i sesamfrö med sötsursås	50,00
F4. Friterade bläckfiskringar med sötsursås	50,00			
F5. Friterade räkor med sötsursås	50,00			
F6. Tom yam (stark thaisoppa)	65,00			
Med räkor eller skaldjur				

VARMRÄTTER

1. Käeng Pet med ris o sallad	100,00		17. Pad Si Que	100,00
Rödcurry gryta med kött el. kyckling, bambuskott, kokosmjölk, basilika, paprika, gröna bönor				
2. Käeng Khiew whan ris o sallad				
Gröncurry gryta med kött el. kyckling, bambuskott, kokosmjölk, basilika, paprika, gröna bönor				
Stekta donutfröer med levande el. kött el. räkor, merat				

Bishop Arms

<https://www.bishopsarms.com/vara-hotell/lund/>

Burger place at Lund C



Espresso House..