



System Acceptance Review meeting for DREAM

DREAM Network Infrastructure

=ESS.INFR.W02.W03.W52

Timing System Infrastructure

=ESS.INFR.K01.K312

PRESENTED BY JOHAN CHRISTENSSON

2026-03-23

Status Report

Network and Timing System Infrastructure



System name	FBS	CIDL	EPL	Delivered	Installed	Verification	Instrument Integration
Network Infrastructure Timing System Infrastructure	=ESS.INFR.W02.W03.W52 =ESS.INFR.K01.K312	CIDL OS-000038 CIDL OS-000036	ePlan: ESS-5233564	Requirement specification: ESS-4390089	DREAM Installation Drawings: Chess link	Verification report: ESS-5551583	Verification plan: ESS-5689547

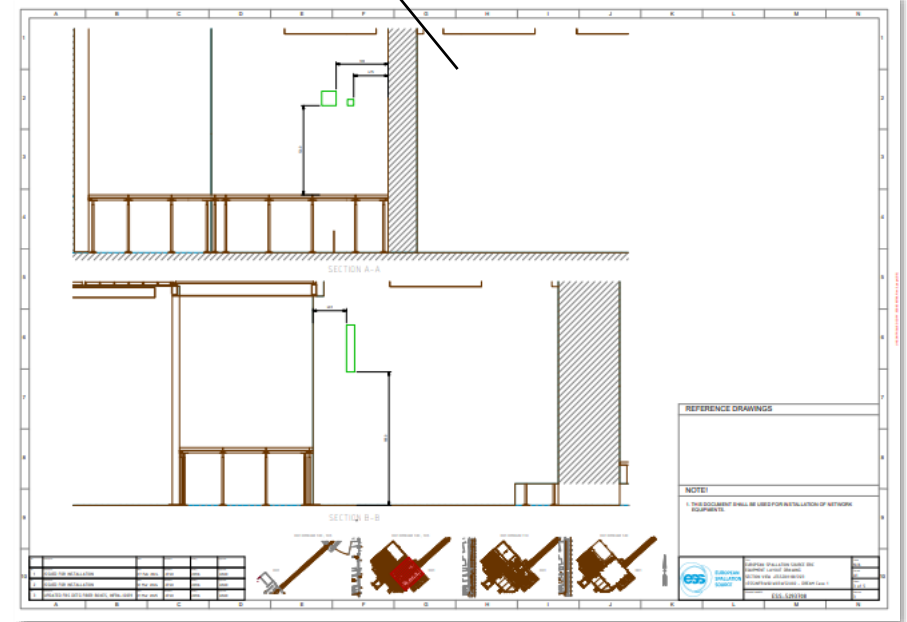
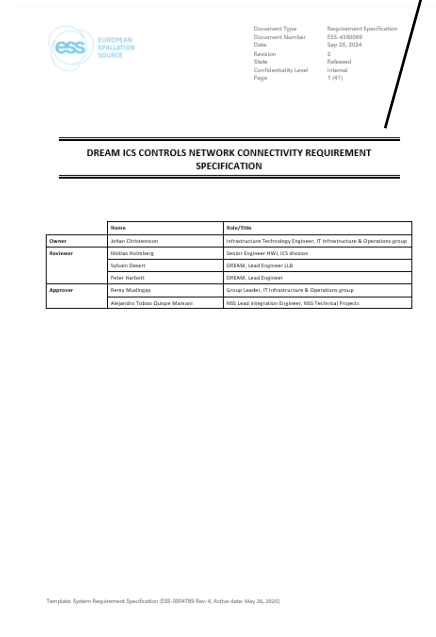
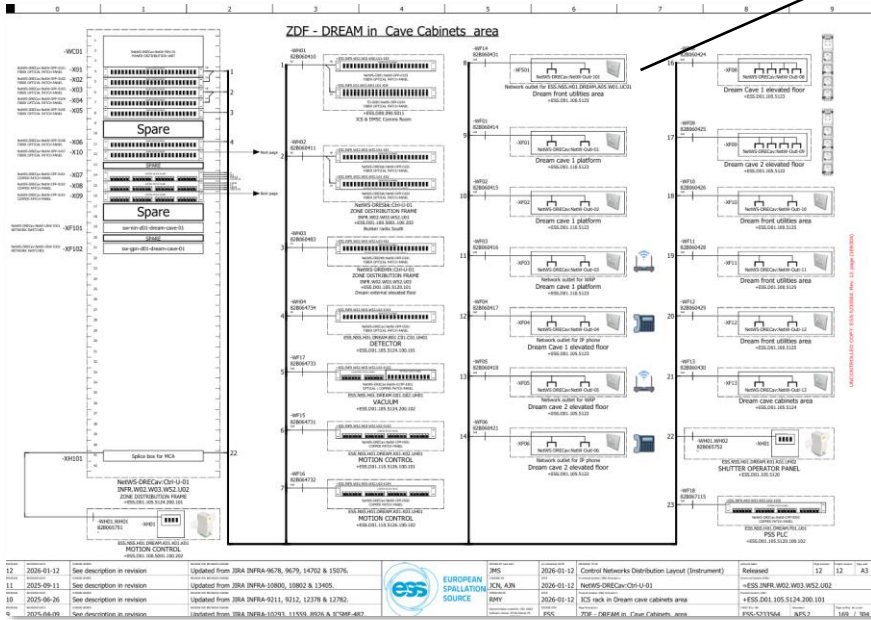

Status Report

Network and Timing System Infrastructure

System scope:

- Infrastructure for **GPN** (General Purpose Network) - Groups of office sub-networks. Used for general use by all ESS users. Access to services like E-mail, ESSOn, Confluence, Internet access, etc. Available on both wired and wireless networks
- Infrastructure for **NIN-CN** (Neutron Instrument Network- Controls Network) - Grouping of sub-networks for the operational technologies. Includes the controls network (EPICS/SCADA systems), including PLC networks, either for facilities control and monitoring (HVAC) or for the machine (LINAC, Cryogenics, Target or Neutron Instrument), as well as radiation and environment monitoring and interfaces to safety or safety related systems. Available on wired networks
- Infrastructure for **NIN-DAQ** (Neutron Instrument Network- Data Acquisition) - Experimental Data acquisition/curation networks. Data analyses, high-performance computing clusters. Available on wired networks
- Infrastructure for Timing system.





Status Report

Network and Timing System Infrastructure

Verification:

- Inspection and test plan ESS-5551586
- Verification of passive and active equipment ESS-5551583
- Instrument integration test plan ESS-5689547

Status:

- Installed and verified.
- Integrated and tested, one Chopper end device with confirmed data flow, synchronization with Timing System and access to Controls System.
- System working as intended.
- System ready for operation.

Table 7: Verification Approval Overview

VERIFICATION APPROVAL	INSTALLATION: Dream	RFQ:217
<input checked="" type="checkbox"/> APPROVED	<input type="checkbox"/> REJECTED	
PASSIVE NETWORK COMPONENTS TEST	PASSIVE NETWORK COMPONENTS TEST	
SIGN: <i>[Signature]</i>	SIGN: <i>[Signature]</i>	
PRINT: <i>Andreas Jönsson</i>	PRINT: <i>Emil Ström</i>	
DATE: <i>2024-11-19</i>	DATE: <i>2024-11-19</i>	
ACTIVE NETWORK COMPONENTS TEST		
SIGN:		
PRINT:		
DATE:		

Table 1: Verification Approval Overview

VERIFICATION APPROVAL	INSTALLATION: DREAM	RFQ: 217	
<input checked="" type="checkbox"/> APPROVED	<input type="checkbox"/> REJECTED		
PASSIVE NETWORK COMPONENTS TEST	PASSIVE NETWORK COMPONENTS TEST		
SIGN:	SIGN:		
PRINT:	PRINT:		
DATE:	DATE:		
ACTIVE NETWORK COMPONENTS TEST	ACTIVE NETWORK COMPONENTS TEST		
SIGN: <i>[Signature]</i>	SIGN: <i>[Signature]</i>		
PRINT: <i>Andreas Jönsson</i>	PRINT: <i>Johan Christensson</i>		
DATE: <i>2026/01/09</i>	DATE: <i>2026-01-09</i>		
TESTS TO BE PERFORMED	SUMMARY FINDINGS		
	Passed	Not Passed	NA
<i>Tests to be performed may be adjusted as applicable</i>			
1. Visual inspection	<input checked="" type="checkbox"/>	<input type="checkbox"/>	<input type="checkbox"/>
Comments:			
2. Passive Network components test	<input type="checkbox"/>	<input type="checkbox"/>	<input type="checkbox"/>
Comments:			
3. Active Network components test	<input checked="" type="checkbox"/>	<input type="checkbox"/>	<input type="checkbox"/>
Comments:			



Hot commissioning

Network and Timing System Infrastructure

Network and Timing System Infrastructure ready for hot-commissioning – verification passed.

ICS/IT planned activities for hot commissioning:

- Support instrument team with network infrastructure related issues
- On-call support (part of Controls infrastructure regular on-call schedule)

Maintenance

- Power Distribution units in ICS/IT racks to be included in EAM maintenance plans (Yearly basis).
- Software for Active equipment updated according to maintenance schedule.
- All other equipment -> replace if broken