

---

---

**DM--ID-TBSIDDH09-Connections to Earthwork systems H09.pdf**

---

---

	<b>Name</b>	<b>Role/Title</b>
<b>Owner</b>	Magnus Lindström	HVAC Designer
<b>Reviewer</b>	Andreas Abrahamsson	Structural Designer
	Patrik Persson	HVAC System Owner
	Tobias Hörnfeldt	Requirement engineer
	Martin Hansson	Process System Owner
	Per Persson	ES&H representative
<b>Approver</b>	Boris Kildetoft	Building Owner

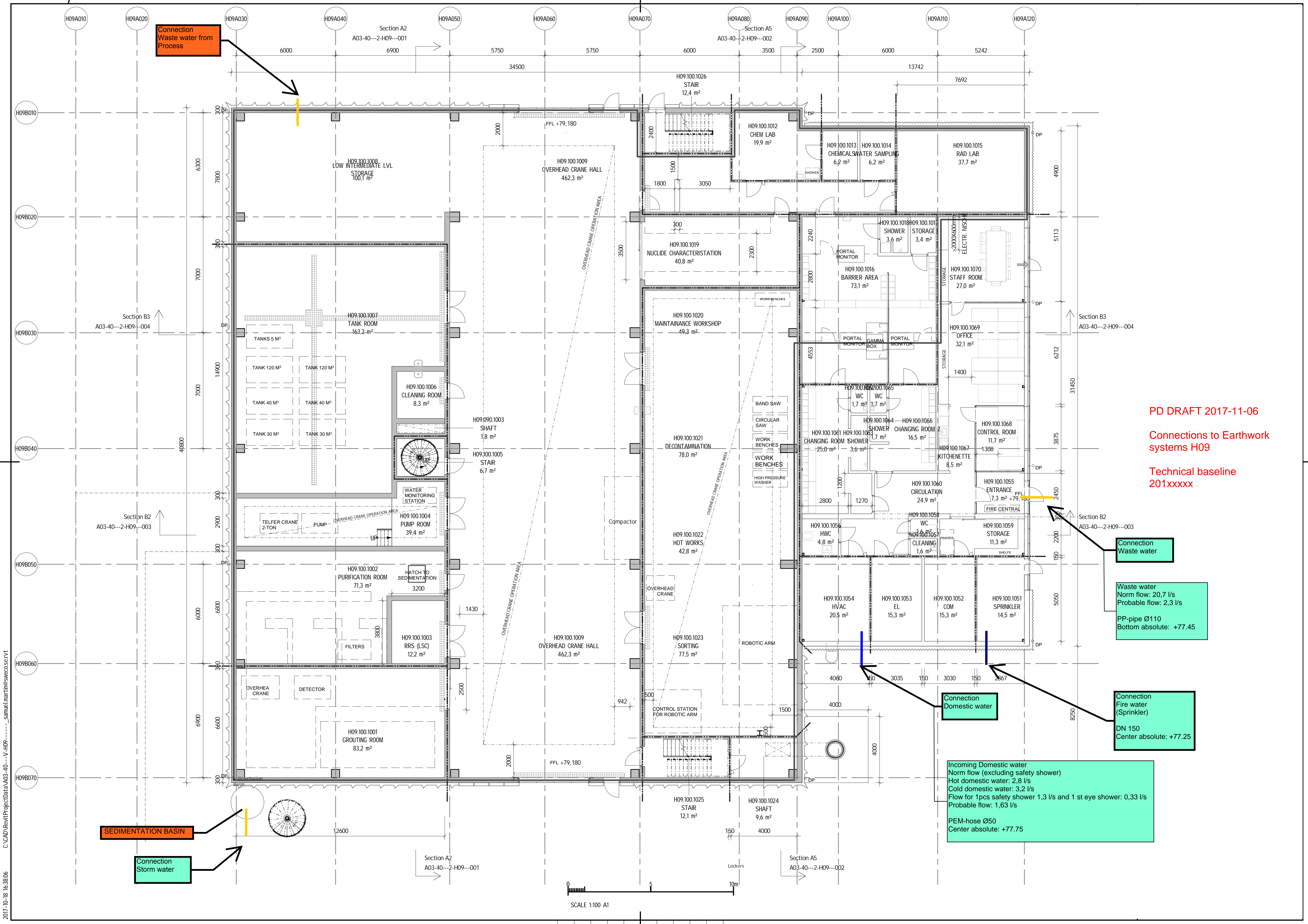

Connection  
Waste water from  
Process

SEDIMENTATION BASIN

Connection  
Storm water

PD DRAFT 2017-11-06

Connections to Earthwork  
systems H09

Technical baseline  
201xxxxx

Connection  
Waste water

Waste water  
Norm flow: 20.7 l/s  
Probable flow: 2.3 l/s  
PP-pipe Ø110  
Bottom absolute: +77.45

Connection  
Domestic water

Incoming Domestic water  
Norm flow (excluding safety shower)  
Hot domestic water: 2.8 l/s  
Cold domestic water: 3.2 l/s  
Flow for 1 pcs safety shower 1.3 l/s and 1 st eye shower: 0.33 l/s  
Probable flow: 1.63 l/s  
PEM-hose Ø50  
Center absolute: +77.75

Connection  
Fire water  
(Sprinkler)  
DN 150  
Center absolute: +77.25

SCALE 1:100 A1

C:\CAD\Revit\ProjectData\A03-40-V-H09-...\_samuel.martins@sweco.se.rvt

2017-10-18 16:38:06